

## RADIATOR SUPPORT (ASSY)

### REPLACEMENT

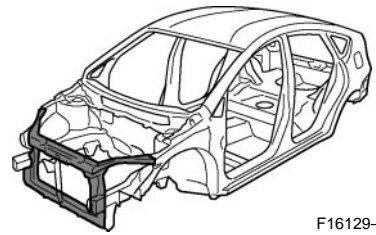

F16129-A

### REMOVAL

[RHD]

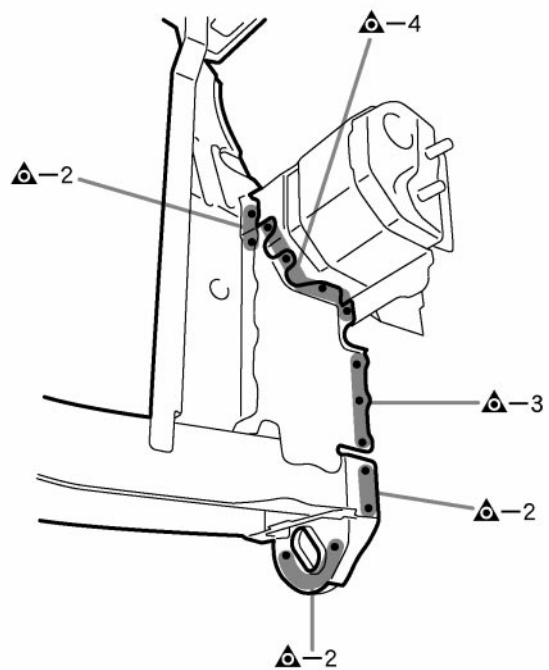
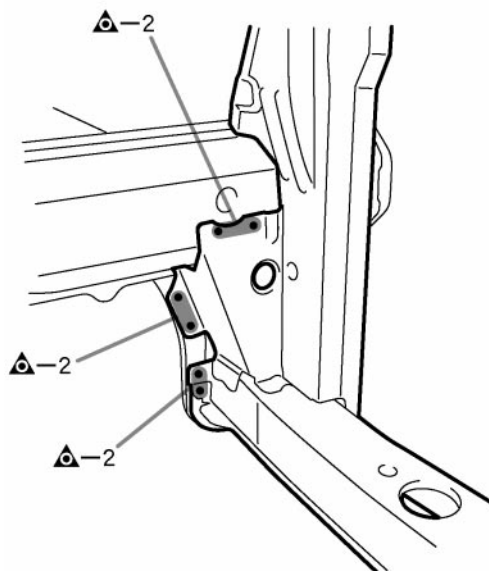
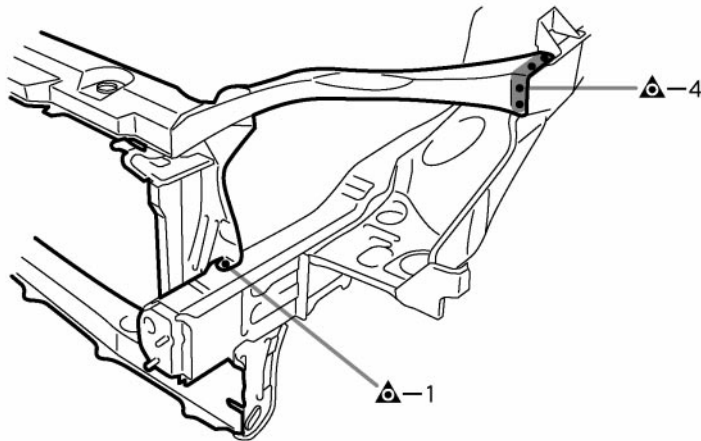

F16129

[LHD]

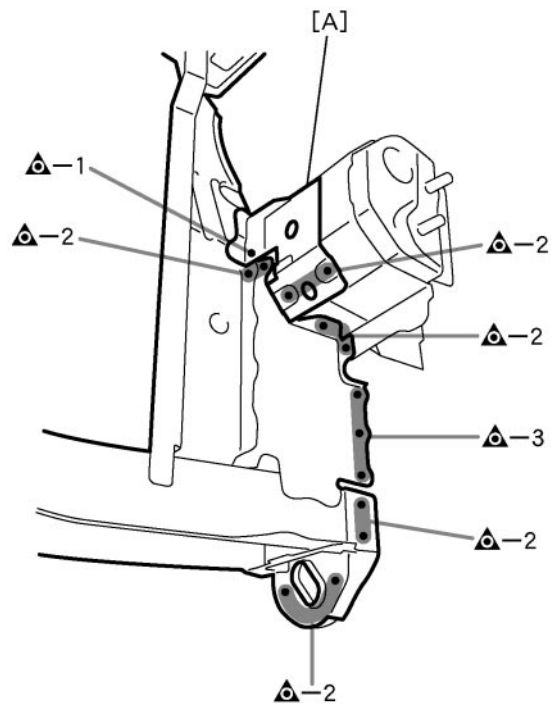
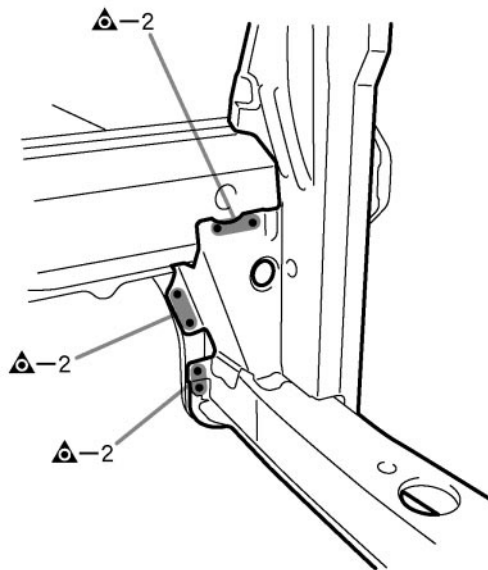
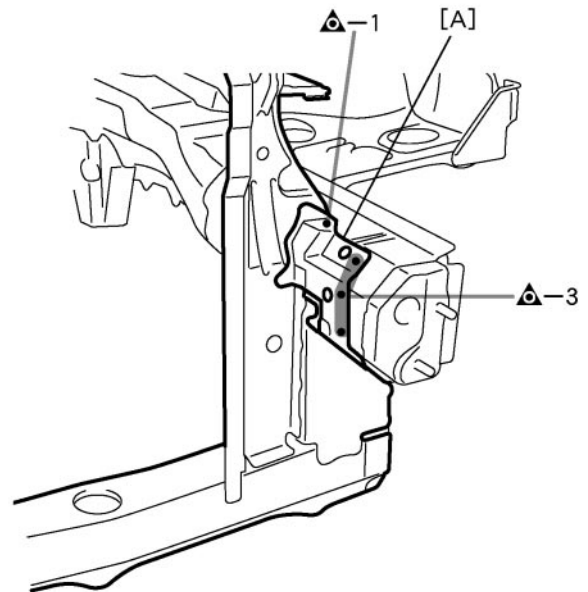
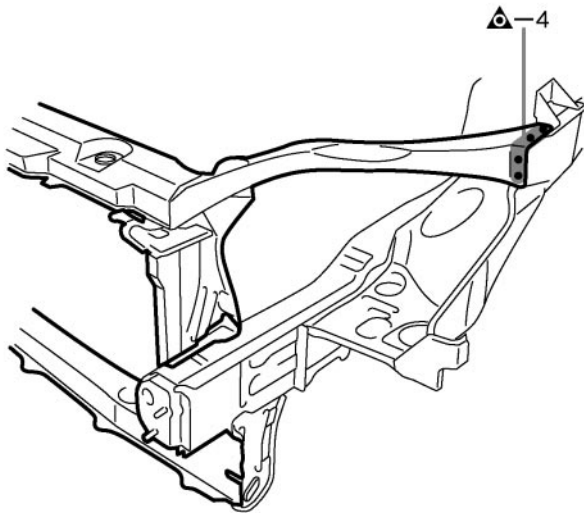

F16130

**POINT**

1 Remove the [A] at the same time.

**PART NAME**

[A] Front Sidemember Support

**INSTALLATION**

- Temporarily install the new parts and measure each part of the new parts in accordance with the body dimension diagram. (See the body dimension diagram)
- Inspect the fitting of the related parts around the new parts before welding. This affects the appearance of the finish.
- After welding, apply the polyurethane foam to the corresponding parts.
- After welding, apply body sealer and under-coating to the corresponding parts.
- After applying the top coat layer, apply anti-rust agent to the inside of the necked section structural weld spots.

[RHD]

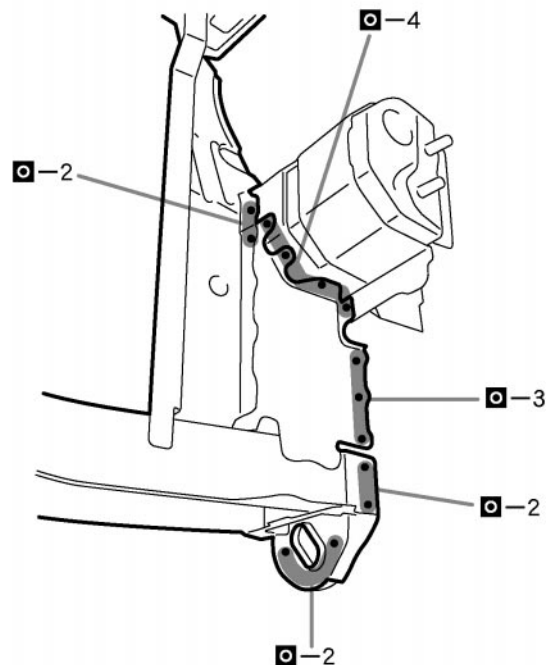
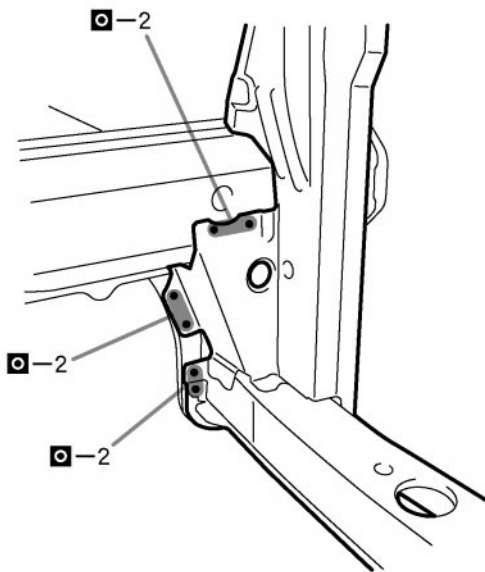
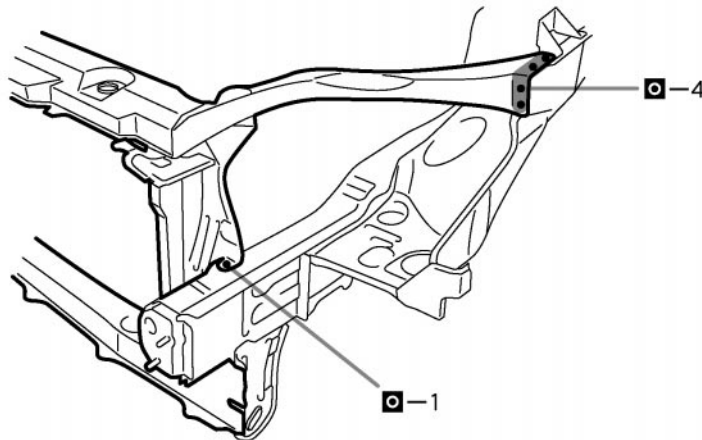

[LHD]

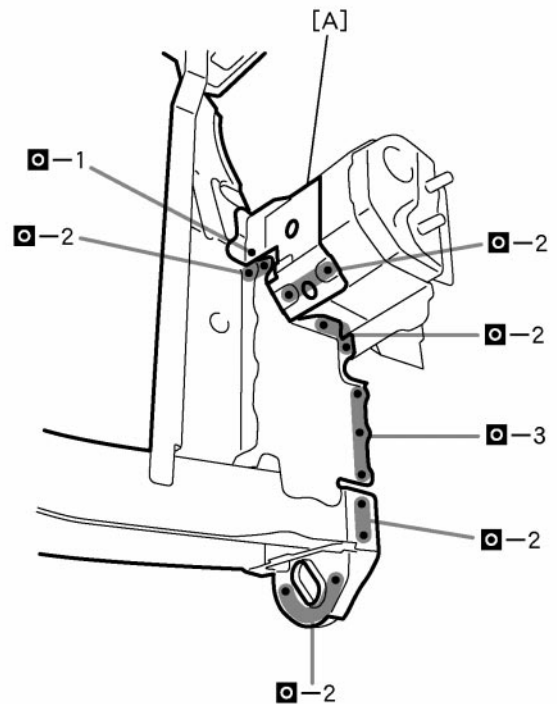
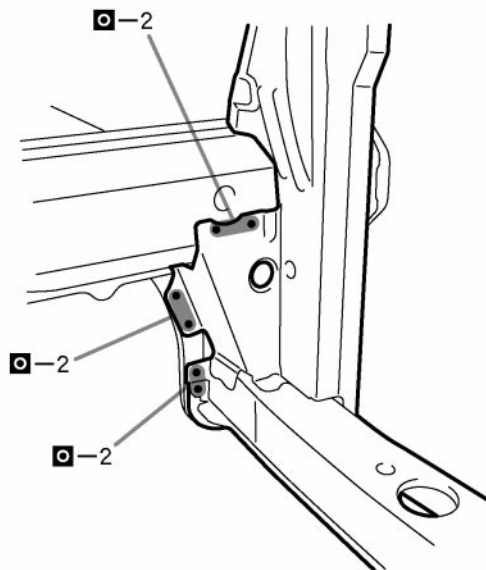
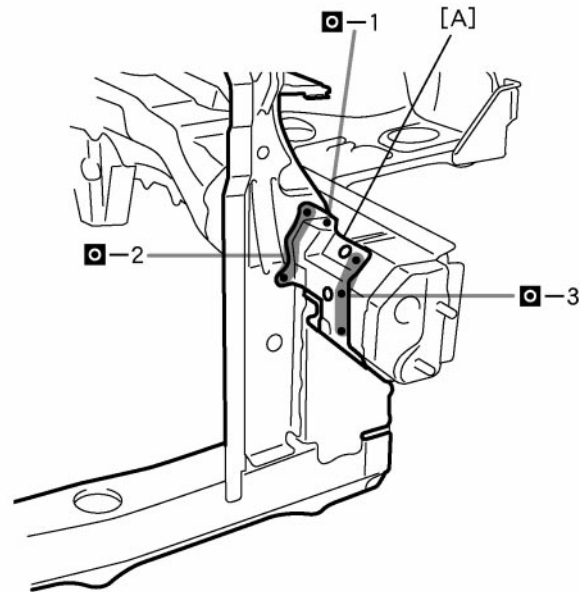
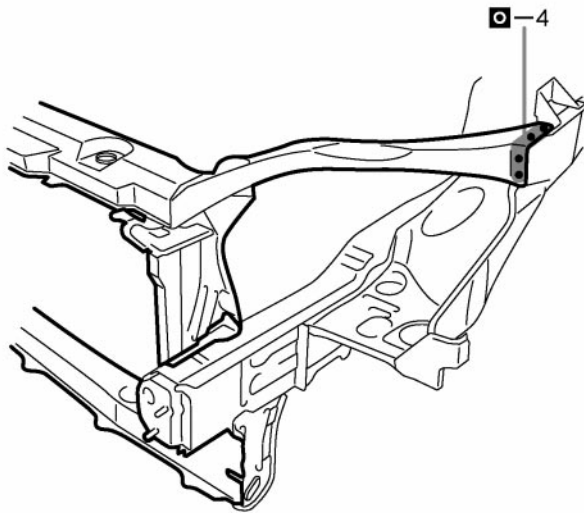

F16132

**PART NAME**

[A] Front Sidemember Support